

# FLAT CLINCH

MAX

## Heavy Duty Electronic Stapler EH-110F

EH-110F can staple with precision up to

**100** sheets  
of paper.

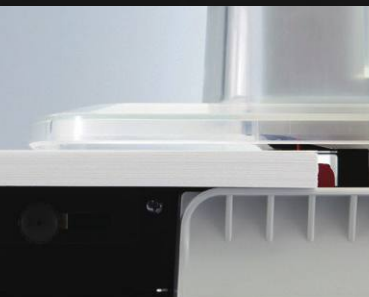

Made in Japan

*"Auto cutting staple legs"*  
and *"Flat Clinch"*  
mechanisms provide a beautiful stapling finish.

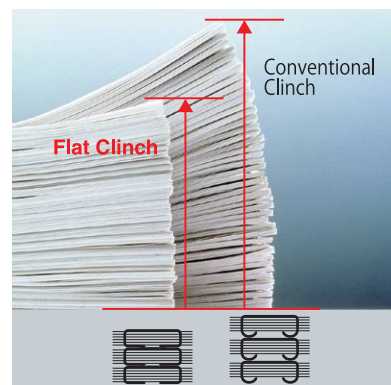
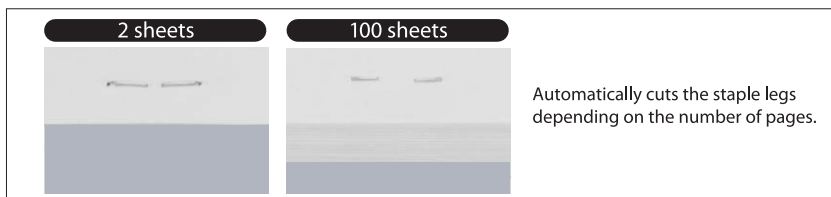

# EH-110F provides you with professional-quality stapling.

## Auto & Manual stapling switch

It is possible to select between "Auto-stapling" and "Manual-stapling" using the selector switch.



## LED indication lamp

Easily know when you need to replace/clear/feed staples by the color and flash of the LED indication lamps.

## User-friendly paper table

Wide paper table prevents papers from being dropped or bent. Guide lines help you staple at suitable positions and equal intervals.



## Clear case

Allows you to see the actual stapling position clearly from any angle.



## Adjustable stapling depth

Stapling depth has an adjustable range of approx. 1/8" to 7/8" (3 to 23mm).

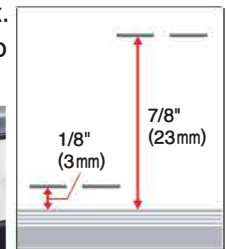

## Reusable staple cartridge uses staple refills

New staple cartridge is reusable and you only need to replace staple refills No.110FE. One refill can staple 4,000 times.

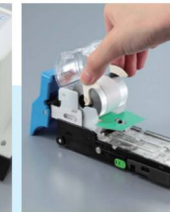

Easily clear jammed staples.

## SPECIFICATIONS

Model Name	EH-110F
Capacity	2-100 sheets (depends on type and weight of the paper)
Stapling speed	2 staples per second (0.5 second per staple)
Throat depth	Adjustable approx. 1/8" to 7/8" (3 to 23mm)
Dimensions	9-9/16"(W) × 15-1/2" (D) × 8-5/16"(H) (242mm × 393mm × 210mm)
Weight	16.76 lbs (7.6kg)
Power source	AC100 - 240V, 50 - 60Hz
Usable staple	MAX Staple Refills No.110FE (Comes with one free staple refill.)

## MAX Staple Refills No.110FE

4,000 staples/roll  
(2 rolls per box)



### staple size

1-9/16" (39mm)

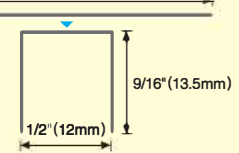

## MAX Electronic stapler series

### EH-20F

20 sheets



MAX No.20FE  
staple cartridge

Comes with one free  
2,000 load staple cartridge.

### EH-70F

70 sheets



MAX No.70FE  
staple cartridge

Comes with one free  
5,000 load staple cartridge.

(Stapling capacity depends on type and weight of the paper)

The specifications and design of the products in this catalogue will be subject to change without advance notice due to our continuous efforts to improve the quality of our products.



本社 〒103-8502 東京都中央区日本橋箱崎町6-6 TEL.(03)3669-8108代

札幌: TEL.(011)261-7141代 東京: TEL.(03)3669-8141代 広島: TEL.(082)291-6331代

盛岡: TEL.(019)621-3541代 静岡: TEL.(054)205-3535代 四国: TEL.(087)866-5599代

ホームページ <http://www.max-ltd.co.jp/op/>

Dealer:



Tel. +502 2360-1140  
[www.artesgraficasca.com](http://www.artesgraficasca.com)